

# Technical data sheet



BNV33  
**BNV33**

Angle can inter alia be used to connect elements stressed by longitudinal forces

## Features

### Material

**Steel quality:**  
**S250GD + Z275 according to DIN EN10346**

**Corrosion protection:**  
**275 g / m galvanized on both sides 20mm**

### Benefits

- **Easy installation**
- **Connecting to concrete and wood**

## Applications

### Applicable materials

**Concrete, steel, wood, wood products**

### Application area

- BNV angle brackets are used for beam-to-beam or beam-to-concrete joints, e.g. for fastening bulkhead beams to straps in truss structures

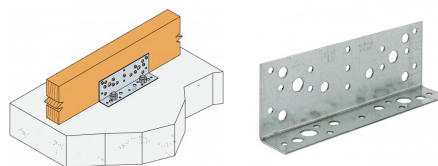

BNV33  
BNV33

## Technical Data

### Dimension

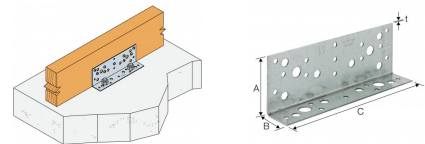

References	DB. nr.	NOB nr.	Dimensions [mm]				Holes		Characteristic load capacity, 1 angle bracket per joint								
			A	B	C	t	Ø	Qty	Beam-to-beam assembly			Beam to concrete			Factor = Bolts / Anchors	Qty per box	Weight [kg]
									Seaming out		R <sub>2/3,k</sub> [kN]	Seaming out		R <sub>2/3,k</sub> [kN]			
									Type	Qty [per bracket]		Type	Qty [per bracket]				
BNV33	5210321	43910822	63	35	180	1.5	5 ; 8.5 ; 11 ; 13	13+7 ; 5+4 ; 2 ; 2	CNA4,0x40	9 + 7	10.7	CNA4.0x40 ; 2 M12 bolt	9 + 2	10.7 max: 10.1/kmod	0.53	50	0.2

### Characteristic load capacity

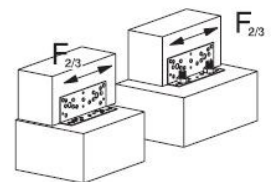

References	Characteristic load capacity, 1 angle bracket per joint						
	Beam-to-beam assembly			Beam to concrete			
	Seaming out		R <sub>2/3,k</sub> [kN]	Seaming out		R <sub>2/3,k</sub> [kN]	Factor = Bolts / Anchors
	Type	Qty [per bracket]		Type	Qty [per bracket]		
BNV33	CNA4,0x40	9 + 7	10.7	CNA4.0x40 ; 2 M12 bolt	9 + 2	10.7 max: 10.1/kmod	0.53

The bolt's shear capacity must be at least  $R_{\text{bolt,lat,k}} = R_{2/3,k}/1,9$

BNV33  
**BNV33**

## Installation

Installation

- Fasten nails or screws CNA4,0xI CSA5,0xI.Pro installation in concrete anchor bolt M12

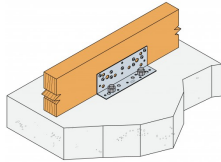

BNV33  
**BNV33**

